

RevNo	Revision note	Date	Signature

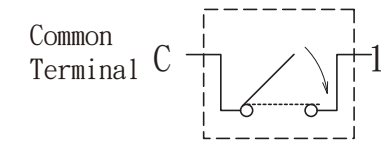

Normal Open Type

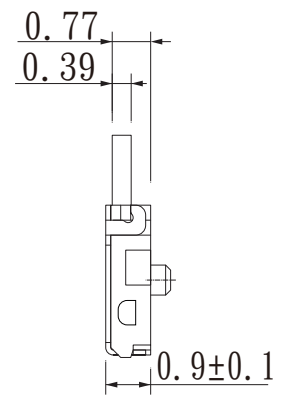
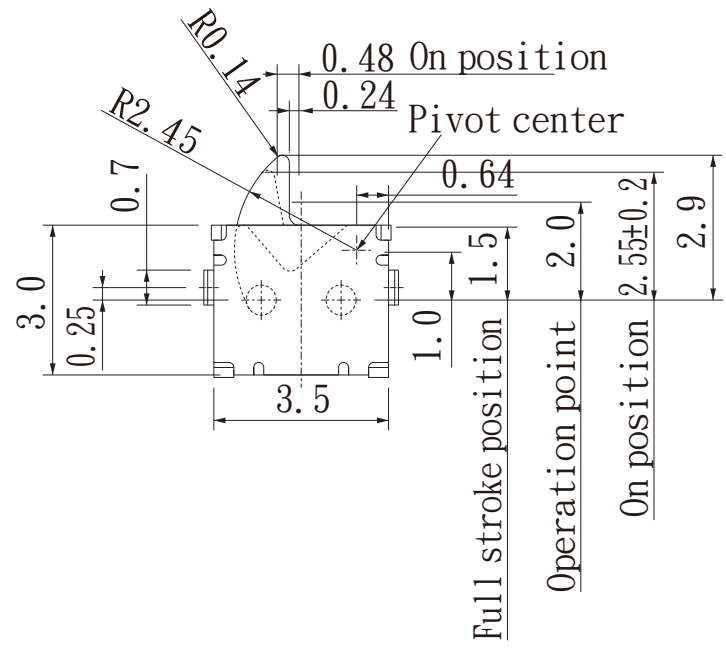
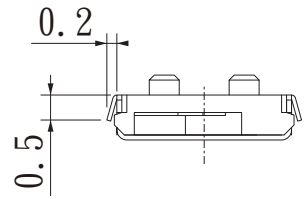
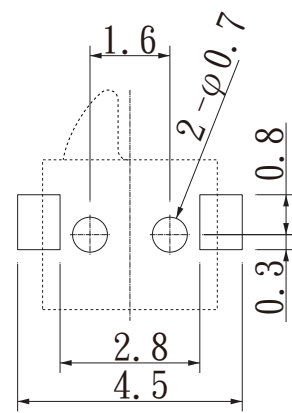
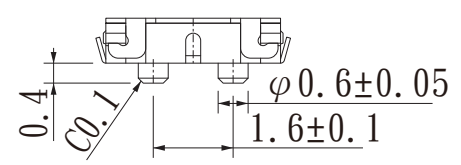

PWB mounting hole
for reference
(Pitch tolerance: ±0.05)

- Specifications
- Rating: 50 uA 3 VDC to 10 mA 5 VDC (Resistive load)
 - Contact Resistance: 500 mΩ max. (Initial)
 - Insulation Resistance: 100 MΩ min. (100 VDC)
 - Dielectric Withstanding Voltage: 100 VAC for 1 minute
 - Operating Force: 300 mN max.
 - Mounting Height: 0.9 mm
 - Poles and Throws: 1-pole 1-throw
 - Full Travel (Pushing distance): With boss : 1.5 mm (1.5 mm)
 - Operating Life: 50000 cycles min.
 - Temperature Range: -10 ° C to +60 ° C
 - Heat Resistance: +70 ° C for 96 hours
 - Low Temperature Resistance: -25 ° C for 96 hours
 - Humidity Resistance: +40 ° C 90 % to 95 % RH for 96 hours
 - Minimum Quantity/Packing Unit: 5000 pcs. Embossed Taping (Reel Pack)
 - Quantity/Carton: 30000 pcs.

Designed by	L.Y.D		 冠泰電子有限公司 CHAMPWAY ELECTRONICS CO., LTD.					
Checked by								
Approved by		Unit	mm	Scale	1/1	Date	2011.10.14	
Item	Detect Switch		Tool	A-Cad	Sheet	1/1	Rev.	0
Model	H:0.9mm Normal Open SMD		Drawing name		ES111AMP-L009R-R			