

NOTE

1. RATING : DC 12V 100mA
2. CONTACT RESISTANCE : 100mΩMAX
3. GENERAL TOLERANCE : +/- 0.2 mm
4. OPERATING FORCE : 100gf min./ 350gf max.
5. LIFE : 10,000 cycles

| RevNo | Revision note | Date | Signature |
|-------|---------------|------|-----------|
| | | | |
| | | | |

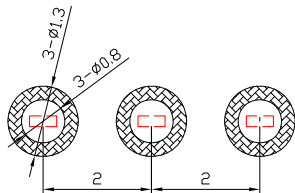

P.C.B LAND DIMENSION

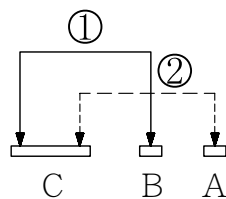

CIRCUIT DIAGRAM

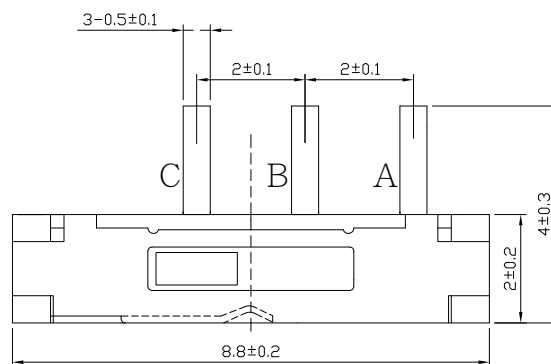
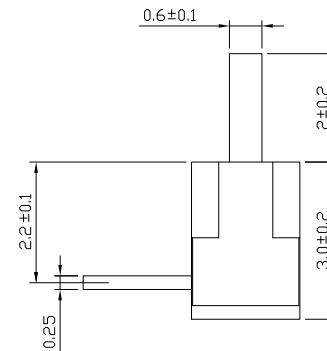
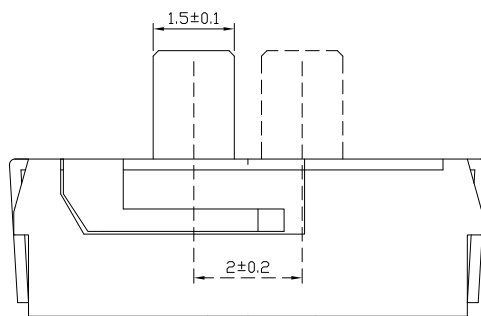

| | | | |
|-------------------------------|--------------------------------|--------------|--------------------|
| Designed by L.Y.D | | | |
| Checked by | | | |
| Approved by | Unit mm | Scale 1/1 | Date 2011.10.14 |
| Item SLIDE SWITCH | Tool A-Cad | Sheet 1/1 | Rev. 0 |
| Model 1P2T RIGHT ANGLE DIP | Drawing name SS1202AH-LLR-B | | |